



<http://www.samsungyepp.com>

Samsung Electronics America Inc.  
105 Challenger Road, Ridgefield Park, N.J. 07660

SERVICE DIVISION  
TEL: 1-800-SAMSUNG (1-800-726-7864)

AH68-00966A (Rev 2.5)

DIGITAL AUDIO PLAYER

**yepp**

**YP-700**

- 2X MP3
- Memory Expansion Slot
- MP3 & WMA Playback
- FM Remote Controller(OPTION)
- Voice Recording Function
- High Speed USB
- D.I.Y. Support
- Upgradeable



# SAFETY (Charger)

# Using the Charger

## Safety symbols information



This symbol indicates uninsulated material within your unit may cause an electrical shock. For the safety of everyone in your household, please do not remove product covering.



The symbol calls attention to features for which you should read the enclosed literature closely to prevent operating and maintenance problems.

**WARNING:** TO PREVENT FIRE OR SHOCK HAZARD, DO NOT EXPOSE THIS EQUIPMENT TO RAIN OR MOISTURE.

**CAUTION:** To prevent electric shock, match wide blade of plug to wide slot, and fully insert.

- A charger is provided with yepp.
- Use only approved NI-MH rechargeable battery and charger.

**1** Insert the rechargeable battery into the battery slot.  
\* Make sure that you put the polarity of the battery in the right direction.

- 2** Plug the charger into a wall outlet.  
\* The charger can be operated from an AC 120V/60Hz source  
\* Red light indicates that battery is being charged.  
\* Green light indicates that battery is fully charged after charging about 4 hours.  
\* When light color changes to green, remove the rechargeable battery from the charger within one hour.

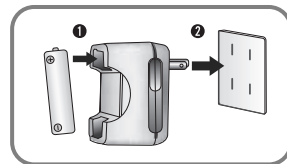

## Warning :

- Never use any charger or battery that is damaged in any way.
- After charging the rechargeable battery, disconnect charger from power source.
- Do not overload the outlet or extension cords.
- The battery can be charged and discharged hundreds of times, but it will gradually wear out. When the operation time is noticeably shorter than normal, it is time to buy a new battery.
- Don't charge the rechargeable battery over 24 hours.
- Overcharging or overdischarging will shorten the life of the rechargeable battery.
- To use the rechargeable battery for long time, repeat full charging and full discharging.
- When using the rechargeable battery for the first time or when left unused for a long time, charge it fully before using it again.
- Do not short-circuit the battery. Accidental short circuiting can occur when a metallic object (coin, clip or pen) causes a direct connection between the + and - terminals of the battery. Short-circuiting the terminals may damage the battery.

# Contents



## Preparations

SAFETY(Charger) .....	2
Using the Charger .....	3
Features .....	6
Components .....	9
Location of Controls (y Tepp) .....	10
Location of Controls (Remote Controller) .....	12
Inserting the Battery.....	14
Using the SmartMedia Card .....	15

## Basic Usage

Listening to Music with y Tepp .....	16
Setting up Volume/Hold Functions .....	17
Changing Modes .....	18
Recording Voice.....	19
Searching for Music/Voice Files .....	20
FM Listening Function(All models except YP-700HBB) .....	22

## Additional Usage

Loop Repeating .....	24
Setting up MENU.....	25
Repeating Tracks .....	26
Setting up EQ .....	28
Managing Files .....	30
Customizing Options (Display) .....	34
Searching Quickly For Music/Voice Files .....	37

## Connection to Computer

Connecting y Tepp to PC .....	38
Manual Installation of USB Driver .....	42
Connecting y Tepp to Mac .....	46

## Software Usage

Setting Option Function (PC).....	49
Copying Files to y Tepp (PC) .....	50
Copying Files to y Tepp (Mac) .....	52
Deleting Files (PC) .....	54
Deleting Files (Mac).....	55
Formatting (PC) .....	56
Formatting (Mac) .....	57
Uploading Files (PC) .....	58
Uploading Files (Mac) .....	59
Make MP3 files from an Audio CD (PC) .....	60
Rearranging Files (PC) .....	62
Using Additional Functions through y Tepp Explorer .....	63

## Appendix

Description of Buttons (y Tepp Player) .....	72
MENU Table .....	74

## Customer Support

Precautions .....	76
Troubleshooting .....	77
Security .....	78
Specifications.....	79
Safety Information .....	80
Warranty .....	82

## 2X MP3 (refer to P.66)

MP3 compression technology that allows you to downsize your MP3 files via software.

## Upgradeable

You can upgrade the built-in programs if necessary.

ex) Add functions, CODEC, etc.

Please refer to the yepp home page (<http://www.samsungyepp.com>) when you need to upgrade your yepp.

## Memory Expansion Slot (refer to P.15)

You can expand 8MB~128MB by adding a SmartMedia card.

## MP3 & WMA Playback

MP3 is an MPEG1 Layer3 audio format.

WMA is a Microsoft Windows Media audio format.

## FM Remote Controller (Option, refer to P.22)

Capable of storing 5 stations

## D.I.Y.

- Setting up EQ (refer to P.28)
- LOGO Embellishment (refer to P.35)
- Changeable LCD Fonts (refer to P.64)
- Adjustable Scroll speed (refer to P.36)
- Adjustable Contrast (refer to P.36)

# DIGITAL SOUND yepp'

## Playing Time

This unit uses a NI-MH rechargeable battery  
Operation can last 20 hours (AAA alkaline battery + rechargeable battery)

## Backlight (refer to P.36)

Blue-color backlight

## High Speed USB

Download speed Max. 5Mbps

## Sound

You can adjust equalizer manually.

## Voice Recording Function (refer to P.19)

Suitable for recording lectures and meetings

## Components



yepp'  
Player



Remote Controller



Earphone



USB Cable



Installation  
CD

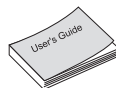

User's Guide



Charger



Rechargeable Battery  
Auxiliary (1.2V NI-MH)



Auxiliary Battery  
Pack



Carrying case  
(Option)

Model	YP-700i	YP-700H	YP-700S
Built-in memory	192MB	128MB	64MB

- SmartMedia Card(3.3V) and Disposal Battery(AAA type) are not included.
- Design of accessories is subject to change for improvement without notice.

# Location of Controls (yep!)



## Front

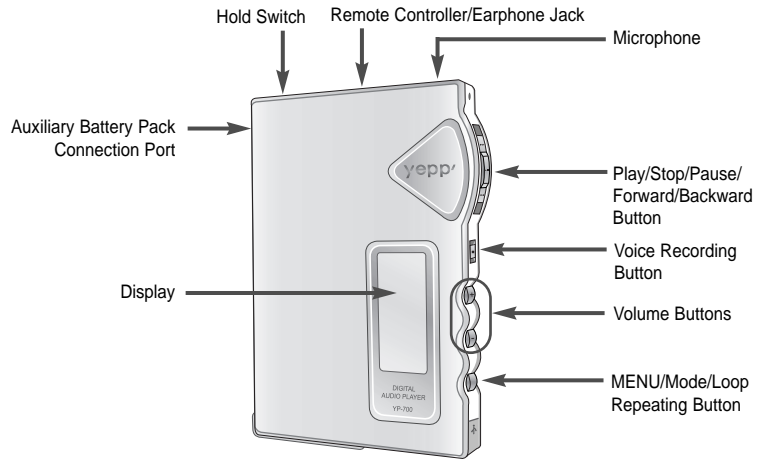

## Rear

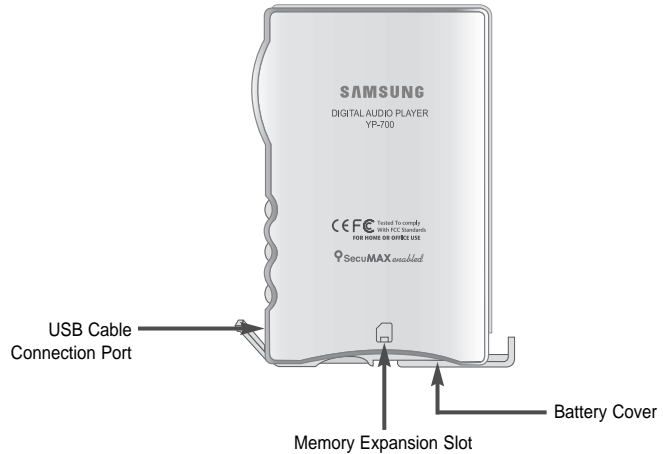

# Location of Controls (Remote Controller)



## Models with FM (All models except YP-700HBB)

## Model without FM (YP-700HBB)

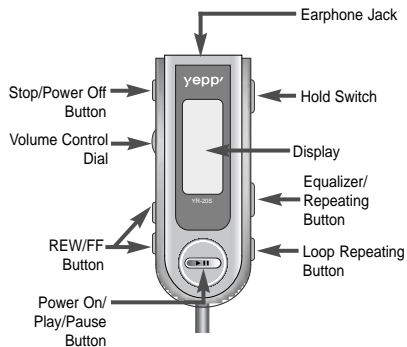
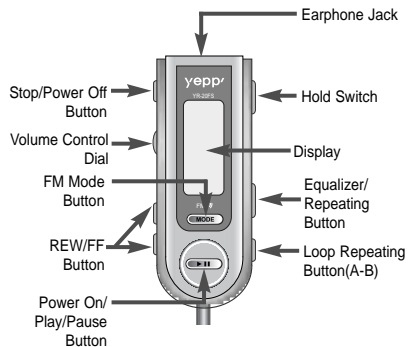

## Display



## Remote Controller Connection

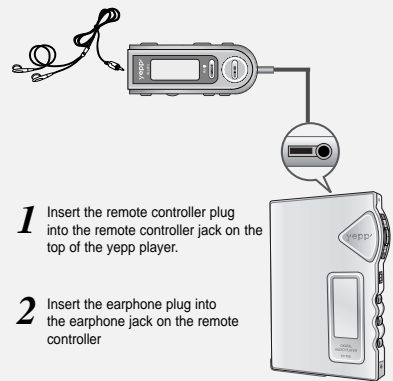

- 1** Insert the remote controller plug into the remote controller jack on the top of the yepp player.
- 2** Insert the earphone plug into the earphone jack on the remote controller

# Inserting the Battery

## Using the Rechargeable Battery

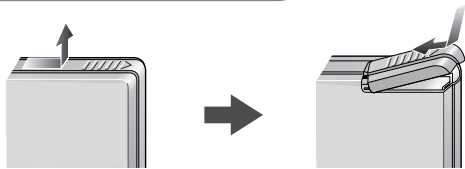

**1** Open the battery cover by pushing it in the direction of the arrow.

**2** Insert the battery into the groove and make sure that you put the polarity of the battery in the right direction. Close the battery cover by pushing it in the direction of the arrow.

## Using a Disposal Battery

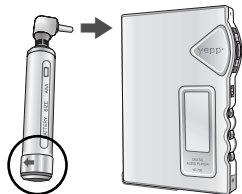

- 1** Open the battery pack cover in the direction of arrow.
- 2** Insert the battery correctly and close the battery pack cover.
- 3** Plug the battery pack into the extension battery connection port.

# Using the SmartMedia Card

Your yepp player allows you to expand memory capacity by adding a SmartMedia card.

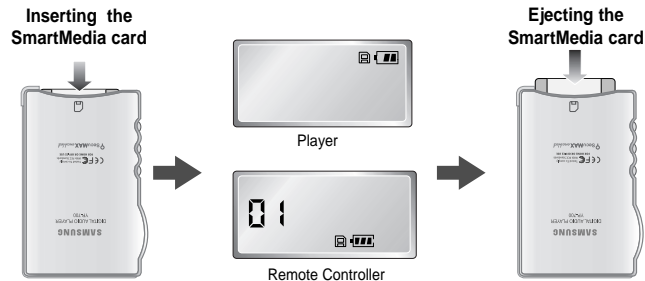

**1** Insert the SmartMedia card into the memory expansion slot on your yepp player in the direction of the arrow.

**2** Confirm the SmartMedia card mark is displayed on the display.

**3** Push the SmartMedia card again in the direction of the arrow to take out the SmartMedia card from the slot.

### Note :

- Do not insert/eject the SmartMedia card during playback of music/voice files.
- Make sure to turn off the player before inserting/ejecting the SmartMedia card.
- Use 3.3V SmartMedia cards only.
- SmartMedia cards of 8MB~128MB can be used.
- Do not touch the metal face of the SmartMedia card.

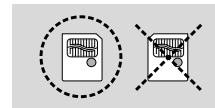

3.3V

5V



# Listening to Music with yepp

First, insert a battery and connect the earphones and the remote controller to the player.

## Playing Music (Power On)

When you press the ►/■ button(yepp player)/ the ►|| button(remote controller), the yepp logo appears and a music/voice file is played.

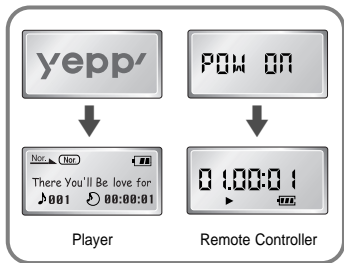

### Note :

- If the ►|| button on remote controller is pressed while playing, yepp is paused.
- WMA file can be played only at a bit rate between 48Kbps and 192Kbps.[supplied by Windows Media Player (Ver 8.0)]

## Stopping Music (Power Off)

When you press the ►/■ button (yepp player) or the ■ button(remote controller) while playing, the music stops. If no buttons are pressed within 5 seconds, the yepp automatically powers off.

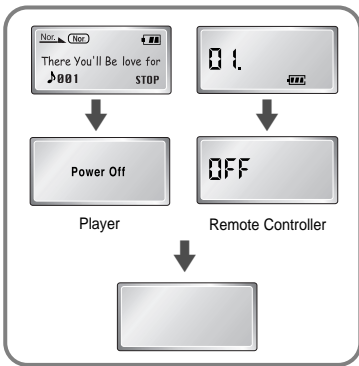

# Setting up Volume/Hold Functions

## Adjusting the Volume

Press the + / - button on the side of the yepp player to adjust the volume while playing.

**Note :** Volume ranges from 00 to 30.

- Press briefly to adjust step by step.
- Press and hold to adjust continuously.

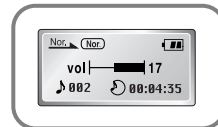

## HOLD Function

Under Hold mode, no buttons work.

### HOLD function on the player

Slide the switch on the player in the direction of the arrow.

- Then no buttons on the yepp player will work. Only the remote controller buttons will work.
- When a button is pressed, "Hold" message will appear on the display.
- The mark will appear on the display.



### HOLD function on the remote controller

Slide the switch on the remote controller in the direction of the arrow.

- The mark will appear on the display. No buttons on the remote controller will work. (Volume control dial will work.) Only the yepp player buttons will work.



# Changing Modes

Press the **MODE** button on the yepp player or the **A-B** button on the remote controller in **STOP** mode.

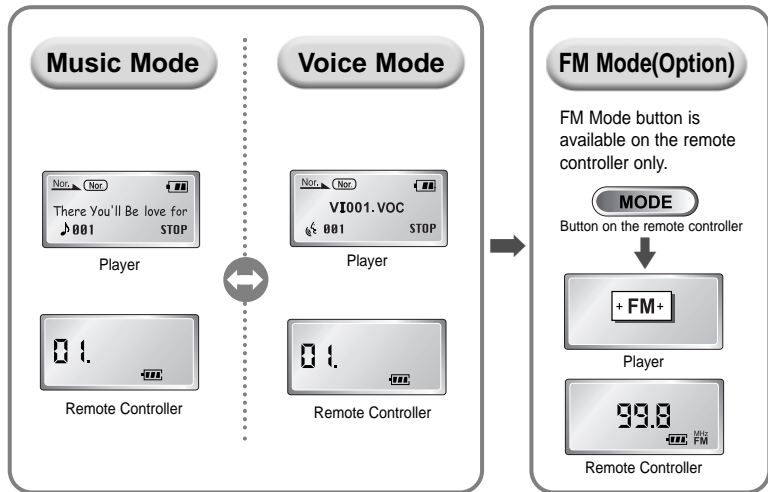

# Recording Voice

## To Record Voice

- 1** Press the **REC** button(player) in **STOP** mode.
  - Use the **◀▶** button to select built-in memory/SmartMedia card and start recording using the **REC** or **▶■** button
- 2** Press the **▶■** button to pause while recording. Press the **▶■** button again to resume recording.
- 3** Press the **REC** button to stop recording. A new voice file is created.
  - The Voice messages are recorded on the built-in memory or SmartMedia card in order of VI001, VI002.....

### Note :

- When the recording function does not work well, format the relevant memory first before starting recording again.
  - Voice recording function button is available on the player only.
  - Do not take out or insert the SmartMedia card while voice recording is under way.
  - When memory is full, recording stops automatically.
- (The available time is displayed on the right of display(player) when recording begins.)

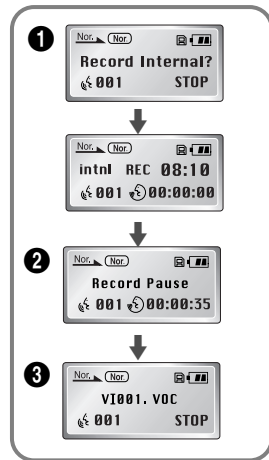

# Searching for Music/Voice Files



## Searching for Specific Parts in PLAY Mode

Press and hold the ◀◀/▶▶ button while playing to find the part you want to listen to.

Release the ◀◀/▶▶ button to resume playing.

### Note :

- With VBR files, pressing the ◀◀ button within the first 5 seconds of the start of track may not result in the previous track playing.
- With VBR files, the actual running time may differ from that of the player display.
- VBR(Variable Bit Rate) file: MP3 file whose compression rate changes when played.

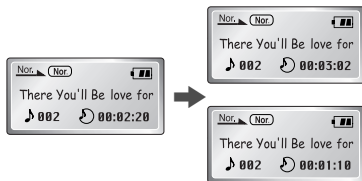

## Searching for Music/Voice Files in PLAY Mode.

Press the ▶▶ button briefly while playing to advance to the next track.

Press the ◀◀ button briefly within 5 seconds from the start of the track to play the previous track. Press the ◀◀ button briefly after 5 seconds from the start of the track to play the beginning of the current track.

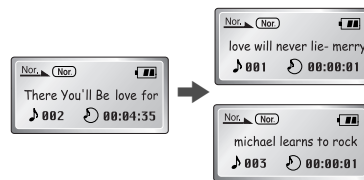

## Searching for Music/Voice Files in STOP Mode.

Press the ◀◀/▶▶ button in STOP mode to skip to the previous or next track.

Press the ▶/■ button to play.

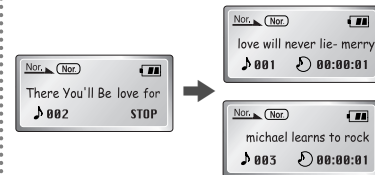

# FM Listening Function (All models except YP-700HBB)



Turn on the power of yepp and connect the remote controller.

## Switching to FM Mode

Press the **MODE** button on the remote controller.



Player



Remote Controller

## Automatic Searching for FM Frequency

Press and hold the **◀/▶** button on the remote controller.

- Auto search for frequency will start.



Remote Controller

## Manual Searching for FM Frequency

Press the **◀/▶** button briefly on the remote controller.

- Manually set the frequency that you want.



Remote Controller

## To Save a Radio Station

**1** Press the **EQ/REP** button on the remote controller for the radio station frequency that you want to store.



**2** Press the **A-B** button to select the location to save.

Select the location to save a Radio Station



**3** Press the **EQ/REP** button to save a Radio Station.

Save a Radio Station



- Select one of the following locations: a, b, c, d, or e

- The radio station frequency is saved in the chosen location

### Note :

- Only buttons on the remote controller will work in the **FM** mode.
- In FM mode, you can't connect yepp to a computer.
- Backlight function of the remote controller display will not work in the **FM** mode.
- To exit **FM** mode, press the **MODE** button.

### Note :

- Up to five stations (a, b, c, d, and e) can be saved.
- You can replace one station with another at each saved location, but it is not possible to delete a saved station.
- Press the **A-B** button to access the saved location directly.

# Loop Repeating

## Loop Function

### Starting Point

While playing music/voice files, press the **MODE** button briefly (yepp player)/ the **A-B** button (Remote controller) at the beginning of the loop you want to set.

 flickers in the display.



### Ending Point

Press the **MODE** button briefly (yepp player)/ the **A-B** button (Remote controller) at the end of the loop.

 appears in the display.  
The loop is played repeatedly.

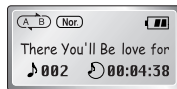





#### Note :

Press the **MODE** button briefly (yepp player)/ the **A-B** button (Remote controller) to cancel the loop.

# Setting up MENU

Press and hold the **MODE** button on the yepp player to switch to **MENU** mode.

Use the /  button to select and the /  button to move.

Press the **MODE** button one more time to cancel the **MENU** mode.

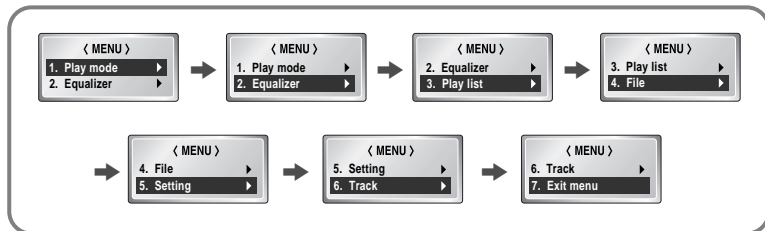

- **Play mode** : To select track repeating mode.
- **Equalizer** : To use equalizer function.
- **Play list** : To select files to listen to.
- **File** : To delete or format music/voice files.
- **Setting** : To change the basic setup options of the display.
- **Track** : To search for the file quickly.
- **Exit menu** : To exit **MENU**.

#### Note :

- In **MENU**, **Go up** can be used to exit the current setting.
- In **MENU** mode, no input for 10 seconds will cancel the **MENU** mode.

# Repeating Tracks



## Track Repeating Function On the yepp Player

- 1 In **MENU**, select **1.Play mode**.
- 2 In **PLAY MODE**, use the ◀◀/▶▶ button to move to the mode you want and press the ▶/■ button to select.

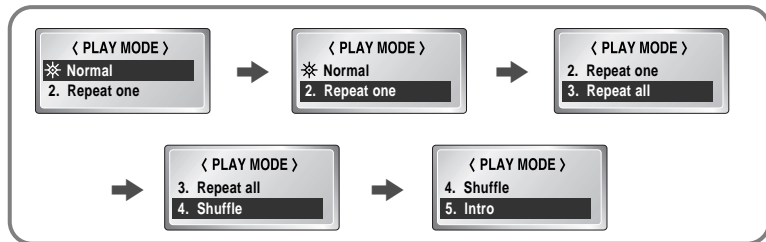

- **Normal**: To play all the tracks in order one time. Nor.
- **Repeat one**: To repeat one track. One
- **Repeat all**: To repeat all tracks. All
- **Shuffle**: To play tracks at random. S
- **Intro**: To play the first 10 seconds of each track. intro

## On the Remote Controller

Each time the **EQ/REP** button is pressed and held, the mode will change in order of **REP**, **ALL**, **SHU**, **INT** and **Normal**.

- **REP** Repeats one track only.
- **ALL** Repeats all tracks.
- **SHU** Enables random playback.
- **INT** Enables yepp to repeat the first 10 seconds of each track.

### Note :

Normal mode is not indicated on the display.



# Setting up EQ



## EQ Function On the yepp Player

- 1 In **MENU**, select **2. Equalizer**.
- 2 In **EQ**, use the ◀▶/▶▶ button to move to the setting you want (out of the 8 settings) and press the ▶/■ button to select. If you want manual equalizer, select **User** and **Bass/Treble**.



Normal

Classic

Jazz

Rock



Normal-DBB

Classic-DBB

Jazz-DBB

Rock-DBB

### Note :

DBB is for Dynamic Bass Booster, which enhances bass response.

## On the Remote Controller

Each time the EQ/REP button is pressed, the mode will change in order of **Classic, Jazz, Rock, and Normal**.



### Note :

- DBB and User cannot be accessed with the remote controller.
- Normal mode is not indicated on the display.

# Managing Files

Continued...



## Editing Play List

**1** In **MENU**, select **3. Play list**

**2** In **PLAY LIST**, select the mode (Music or Voice) to edit and select **Edit**.

- Select **Delete** to erase play list.



**3** Move to the file to add to **Play list** and press the ►/■ button to add. The file is added to **Play list**.

- Press the ►/■ button again to cancel.



**4** Select **Confirm** to save **Play list**.

- Select **Cancel** not to save **Play list**.

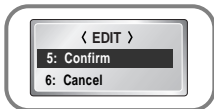

## Listening to Files Selected in Play List

**1** In **MENU**, select **3. Play list**

**2** In **PLAY LIST**, select the mode (Music or Voice) to use Play list and select **On**.

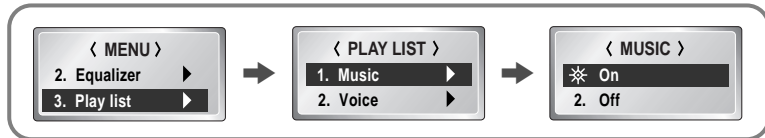

**3** When **Play list** is selected,  is displayed on yepp player. Press the ►/■ button to play the file saved in **Play list**.

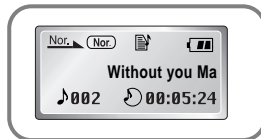





## Deleting

- 1 In **MENU**, select **4. File**
- 2 In **FILE**, select **Delete** and the mode (Music or Voice) the target file is in.
- 3 Move to the file to delete and press the **▶/■** button to select. The file is deleted.
- 4 Select **Go up** → **Cancel** to exit the mode.

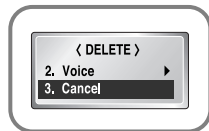
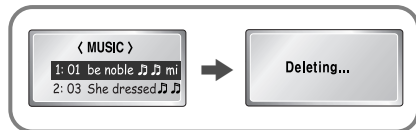
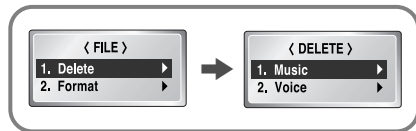

## Formatting

- 1 In **MENU**, select **4. File**
- 2 In **FILE**, select **Format** and the memory to format. Select **Cancel** to exit the mode.

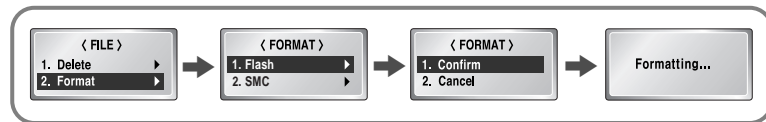

### Note :

- You can also format in yepp Explorer.
- All files will be deleted when formatting the memory.

# Customizing Options (Display)

Continued...



## Setting Function

**1** In **MENU**, select **5. Setting**

**2** In **SETTING**, use the ◀◀/▶▶ button to move to the function you want to change and select the function by using the ▶/■ button.

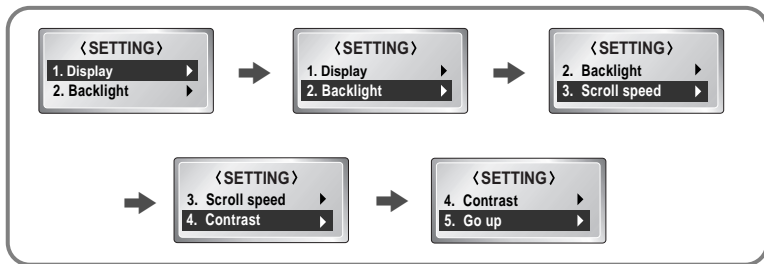

## Display → 1. Information

- **Play time:** displays current play time
- **Remain time:** displays remaining play time
- **Total time:** displays total play time
- **Compression:** displays compression rate 128 Kbps
- **Free memory:** displays remaining memory 12/0 MB FR

## Display → 2. Logo

- **Default:** "yep" logo
- **User define:** displays user-defined logo
- **None:** displays no logo.

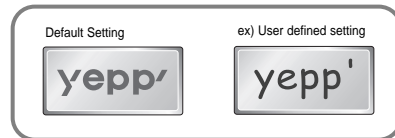

### Note :

yepp homepage (<http://www.samsungyepp.com>) offers a program to edit the user defined logo. You can download from **SUPPORT**.

You can't use yepp logo Editor on Mac.

# Searching Quickly For Music/Voice Files

## Backlight

Press the ◀◀/▶▶ button to set the backlight "ON" time. When a button is pressed, backlight will stay on for the time you set.



## Scroll speed

Press the ◀◀/▶▶ button to set the scroll speed.

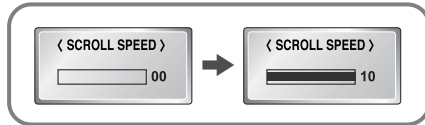

## Contrast

Press the ◀◀/▶▶ button to set the contrast.

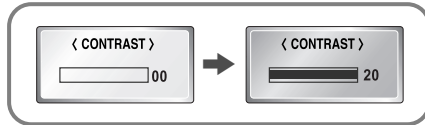

## Track function

- 1 In **MENU**, select **6. Track**
- 2 In **TRACK**, select the memory or the track to listen to first. When **Direct flash** is selected, first track in flash memory is played first. When **Direct SMC** is selected, first track in SMC is played first.

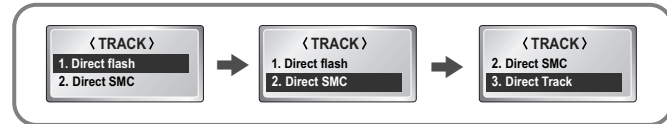

- 3 When **DIRECT TRACK** is selected, select the track number by using the ◀◀/▶▶ button. When the ▶/■ button is pressed, playback starts from the selected track number.

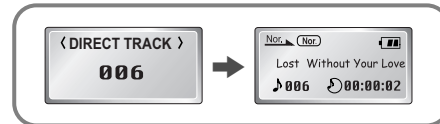

# Connecting yepp to PC

Continued...



Before connecting yepp to PC, make sure to install yepp Audio Manager. If "Add New Hardware Wizard" appears, press the [Cancel] button and install yepp Audio Manager.

## System Requirements.

- Pentium 133MHz or greater
- Windows 98/ME/2000/XP
- 20MB of available hard disk space
- CD-ROM drive (double speed or greater)
- USB port supported
- VGA graphic

## Additional Features

yepp Explorer (refer P.63)

- Fonts Downloading
- 2X MP3

Logo Editor (download from <http://www.samsungyepp.com>)

- Logo Editing

## Installing software

- 1** Insert the Installation CD into CD-ROM drive. The window shown below appears. Select [**yepp Audio Manager**] → [**yepp Audio Manager Install**].



- 2** Click [**Next**] in the series of windows that appear.

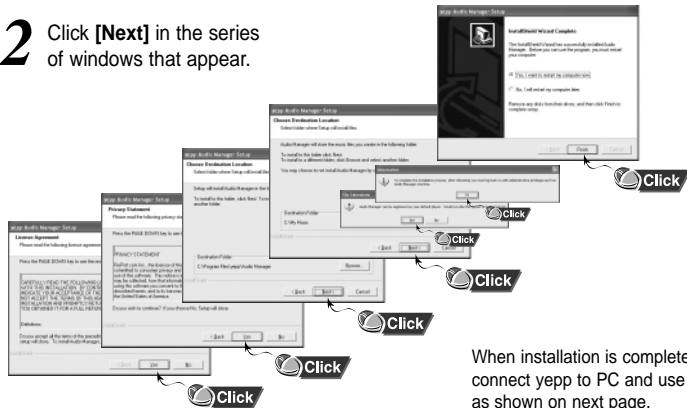

When installation is completed, connect yepp to PC and use it as shown on next page.

- 3** Before using yepp Audio Manager, make sure to set up options (refer to p.49)

**Note :** How to delete the yepp Audio Manager (Rioport Manager):

- [Start] → [Control Panel] → [Add or Remove Programs] → Select the yepp Audio Manager (Rioport Manager) → [Change/Remove] → [OK]
- If yepp Audio Manager (Rioport Manager) is already installed on your PC, remove the existing yepp Audio Manager (Rioport Manager) first before making a new installation.



## Connecting yepp to PC with USB cable

- 1** Insert the battery into yepp and turn on the yepp.
- 2** Plug one end of the USB cable into the USB port on the back of the PC.
- 3** Plug the other end of the USB cable into the USB port on the right side at the bottom.
  - PC may temporarily malfunction if you unplug the USB cable from PC while yepp Audio Manager is initiating or executing a command.
  - USB driver is installed a message saying that it is searching for a new device. If USB driver is not installed, try one more time after rebooting PC.

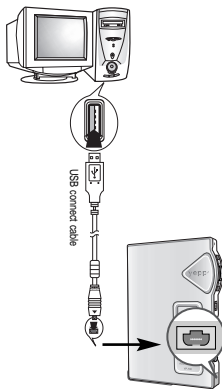

**4** When USB driver is not Installed automatically, refer to next page.

**5** When USB driver is installed, "**SAMSUNG YP-700**" will appear in [System Properties] → [Device Manager] as shown in the picture on the right.

### Note :

#### How to check USB driver

Windows 98,ME:

**Control Panel** → **System** → **Device Manager**

Windows 2000:

**Control Panel** → **System** → **Hardware** →

**Device Manager**

Windows XP:

**Control Panel** → **System** → **Hardware** →

**Device Manager**



# Manual Installation of USB Driver

Continued...



If yepp does not communicate with PC (USB driver can't be installed automatically), turn on the power of yepp and connect yepp to PC, install USB driver manually (How to check USB driver : refer to page 41)

## In Windows XP

- 1 Connect yepp to PC.  
The window shown below appears.  
Select **[Install from a list or specific location (Advanced)]** and click **[Next]**.

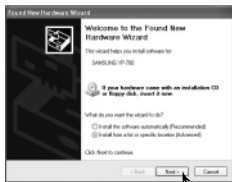

- 2 Insert Installation CD into CD-ROM drive.  
Select **[Search removable media (floppy, CD-ROM...)]** and click **[Next]**.



- 3 Sometimes a POP-UP window including the attention shown below appears.  
This software does not impair or destabilize the correct operation of your system. Click **[Continue Anyway]**

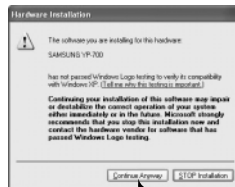

- 4 When Installation is completed, click **[Finish]**.



- If a message asking for the location of the source driver pops up, select the location and execute continuously.



## In Windows 2000

Click **[Next]** button in the series of windows that appear.

Insert installation CD and select drive.

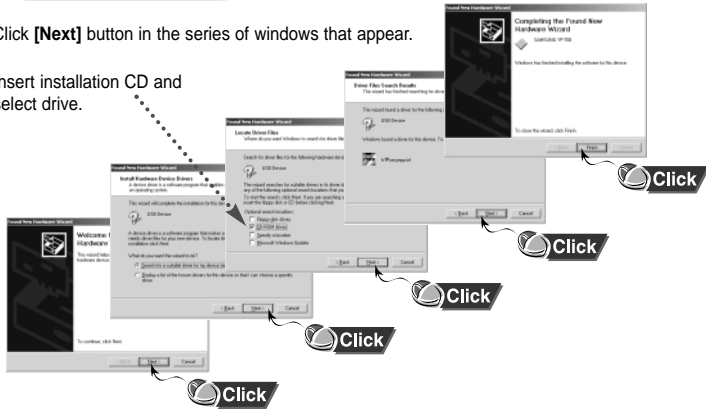

## In Windows 98

Click **[Next]** button in the series of windows that appear.

Insert installation CD and select drive.

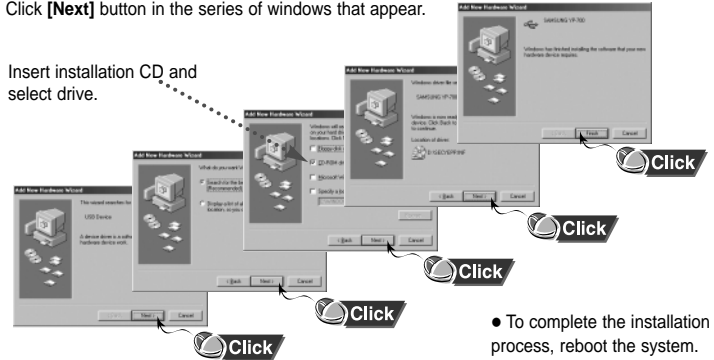

• To complete the installation process, reboot the system.

# Connecting yepp to Mac

Continued...



Before connecting yepp to Mac, make sure to install the iTunes plugin.

## System Requirements.

- Mac (9~10)
- 20MB of available hard disk space
- CD-ROM drive (double speed or greater)
- USB port supported
- iTunes 2.0 & 3.0
  - If it has not been previously installed, install it from Apple's Installation CD.
  - This unit will work on Mac with iTunes 2.0/3.0 only.

### Installing software

- 1** Insert the Installation CD into CD-ROM drive. The window shown below appears. Double-click YP-700 iTunes Installer in Installation CD.



- 2** Double-click Installation program, and screen below appears. Click **[Continue]**.



- 3** Click **[Install]** and Installation starts.



- 4** When Installation is completed, restart system if operating in Mac OS 9. In Mac OS X, you have no need to restart system.



# Setting Option Function (PC)

## Connecting yepp to Mac with USB cable

- 1 Insert the battery into yepp and turn on the yepp.
- 2 Plug one end of the USB cable into the USB port on the back of the Mac.
- 3 Plug the other end of the USB cable into the USB port on the right side at the bottom of the yepp.
  - Mac may temporarily malfunction if you unplug the USB cable from Mac while iTunes is initiating or executing a command.

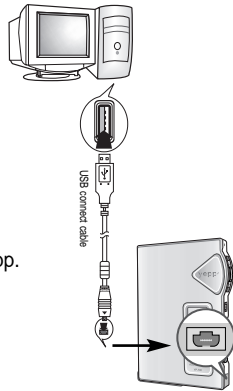

## CD Ripping Settings

- Click on the yepp Audio Manager → [View] → [Options...] → [Read CD] → Set the [Record File As] → Set the [Bit Rate] → Press [OK]

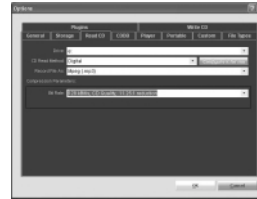

## Device Setting

- Click on the yepp Audio Manager → [View] → [Options...] → [Portable] → Set the yepp YP-700 on [Device] → Press [OK]

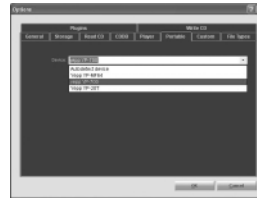

# Copying Files to yepp (PC)



Before copying files, turn on the power of yepp and connect yepp to PC.

- 1** Run yepp Audio Manager.
- Double-click yepp Audio Manager icon on your desktop.



- 2** Click on the [File] → [Search Hard Disks for Tracks] / [Add Tracks...] and save the music files that you want on the database.

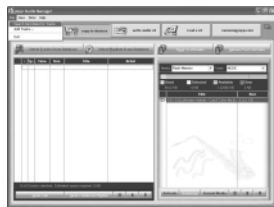

- 3** Select [copy to devices] → [Select Tracks From Database] / [Select Playlists From Database].
- Check the music file to send and click on the [OK] button.
  - If the YP-700 memory capacity is insufficient, a warning message will pop up.



- 4** Click on [Copy To Portable]
- The file is transferred.

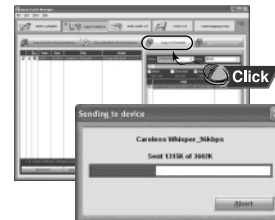

Do you want to save more songs?  
You can use the 2X MP3 function to compress MP3 files.  
[refer to "Using Additional Functions through yepp Explorer" (P.63)]

## Note :

- Total memory size depends on physical characteristics of flash memory.
- A 64Kbps WMA file uses about 512KB per minute.

## Note :

- An 128Kbps MP3 file uses about 1MB of memory per minute.
- Directories are divided according to file extensions(.mp3,.VOC...).
- Open the directory to check the saved file.
- Do not insert or take out the SmartMedia card while a file is being transferred.
- You can't download files to yepp in FM mode.

# Copying Files to yepp (Mac)



Before copying files to yepp, execute iTunes.  
Connect yepp to Mac, turn on the power of yepp and then proceed.

**1** To copy files to yepp, Drag & drop files to iTunes.



**2** Files are saved. Now you can listen to music with yepp after removing the USB cable.



## Note :

- Total memory size depends on physical characteristics of flash memory.
- A 64Kbps WMA file uses about 512KB per minute.

## Note :

- An 128Kbps MP3 file uses about 1MB of memory per minute.
- Do not insert or take out the SmartMedia card while a file is being transferred.
- You can't download files to yepp in FM mode.

## Deleting Files (PC)

Before deleting files, turn on the power of yepp and connect yepp to PC.

**1** Double click the yepp Audio Manager.

**2** Select [copy to devices].



**3** Select the file to delete.

**4** Press the (  ) icon.

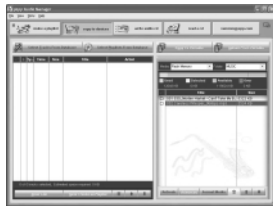

## Deleting Files (Mac)

Before deleting files, execute iTunes.

Connect yepp to Mac, turn on the yepp and then proceed.

**1** Run iTunes.

**2** Select a file to delete.  
It can be deleted one at a time.



**3** Press the “Delete” button on keyboard.



# Formatting (PC)

Before formatting, turn on the power of yepp and connect yepp to PC.

**1** Run the yepp Audio Manager.  
● Double click yepp Audio Manager icon.

**2** Select **[copy to devices]**.



**3** Select Flash Memory or SmartMedia Card on **[Media]**  
● Click on the **[Format Media]** after selecting an item.



## Note :

Make sure to connect yepp to PC and refresh before conducting a format.

# Formatting (Mac)

Before formatting, execute iTunes.  
Connect yepp to Mac, turn on the yepp and then proceed.

**1** Run iTunes.

**2** Click (  ) on iTunes.



## Note :

All files will be deleted when formatting memory.

## Uploading Files (PC)

Before uploading files, turn on the yepp and connect yepp to PC.

**1** Double click the yepp Audio Manager.

**2** Select **[Refresh]**

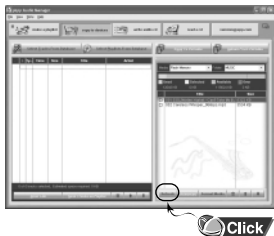

**3** On the right side window, check the file that you'd like to transfer to PC.

● Click on the **[Upload From Portable]**.



**Note :**

- You cannot transfer music files back from the yepp to the PC (due to copyright protection).
- Files recorded as VOC on the player are converted into WAV when they are stored on PC.

## Uploading Files (Mac)

Before uploading files, execute iTunes.

Connect yepp to Mac, turn on the yepp and then proceed.

**1** Run iTunes.

**2** Select files to save in Mac and Drag & drop files to folder to want to save.



\* In case of uploading VOC in Mac, it is saved in VOC.

# Make MP3 files from an Audio CD (PC)



Make sure to install yepp Audio Manager on PC before making an MP3 file.  
You can make MP3 files through yepp Audio Manager.

- 1** Run yepp Audio Manager.
- Double click the yepp Audio Manager.



- 2** Insert the audio CD into the CD-ROM drive.
- Press the [read a CD] button to see CD information.



- 3** Check songs to convert into an MP3 file.



- 4** Press the [Start Reading] button.
- Conversion status is indicated on the right bottom of the window while the file is converted.



- 5** File converting status will be displayed.
- [Options] function should be set first to select the file format. (refer to P.49)

**Note :** The stored file can be found in the Track Directory, which is set [View] → [Options...] → [Storage].

## Rearranging Files (PC)

You can change the order that the files are played.

**1** Double click the yepp Audio Manager.

**2** Select the file to rearrange.

**3** Press the  $\uparrow/\downarrow$  button to move the file.

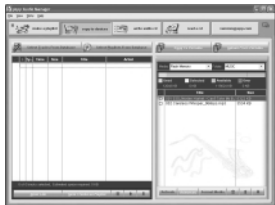

### Note :

- File transfer between the SmartMedia card and Flash Memory is prohibited due to copyright issues.
- File transfer between the directories (Music, Voice) is not allowed.

## Using Additional Functions through yepp Explorer

Continued...

### Installing yepp Explorer

Insert the Installation CD into CD-ROM drive.  
The window shown below appears.

**1** Click on "yepp Explorer".



**3** Click [Next] in the series of windows that appear.

**2** Click on "yepp Explorer install".





## Copying Files to yepp (PC)

Before copying files, turn on the yepp and connect yepp to PC.

- 1** Run yepp Explorer
- Double-click yepp Explorer icon on your desktop.



- 2** Select **[File]→[Copy to]→[Flash Memory] / [SmartMedia Card]**

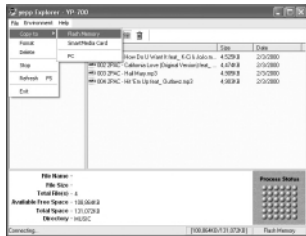

- 3** After selecting files to copy to yepp, click **[Open]**.



- 4** Click **[Copy]**  
(You can select the font you want before copying.)

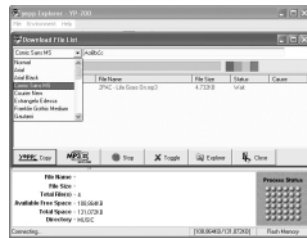

### Note :

- Total memory size depends on physical characteristics of flash memory.
- A 64Kbps WMA file uses about 512KB per minute.

### Note :

- An 128Kbps MP3 file uses about 1MB of memory per minute.
- Directories are divided according to file extensions(.mp3,.VOC...).
- Open the directory to check the saved file.
- Do not insert or take out the SmartMedia card while a file is being transferred.
- You can't download files to yepp in FM mode.



## Downsizing MP3 (PC)

2X MP3 is needed when there is not enough memory space to save more songs.

**1** Before copying, click the  button.

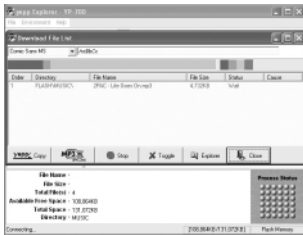

**2** First, select minimum sound quality you want to hear. Displayed minimum file size depends on selected value.

- If selected value is bigger than remaining memory, convertible maximum file size is displayed only.



**3** Move scroll bar with mouse to adjust the file size. Current file size is displayed at center.

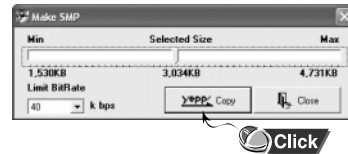

**4** After converted to 2X MP3, files are copied to yepp.

- 2X MP3 can't be saved on PC.



- Note :**
- File types that can be converted to 2X MP3:  
Normal formatted MP3 that has sampling frequency of 22.05KHz or 44.1KHz (WMA and SM3 can't be converted to 2X MP3)
  - 2X MP3 is not available on Mac.

Continued...



## Deleting Files (PC)

Before deleting files, turn on the yjepp and connect yjepp to PC.

**1** Run yjepp Explorer.

**2** Select files to delete.

**3** Click **[File]** → **[Delete]**.

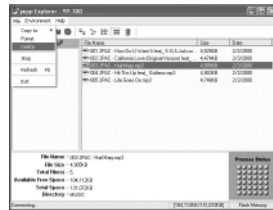
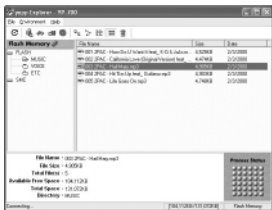

## Formatting (PC)

Before formatting, turn on the yjepp and connect yjepp to PC.

**1** Run yjepp Explorer.

**2** Click **[File]** → **[Format]**.





## Uploading Files (PC)

Before uploading files, turn on the yEPP and connect yEPP to PC.

**1** Run yEPP Explorer.

**2** Select files to upload and click [File]→[Copy to]→[PC].

**3** Select the folder in the computer to save the files in.

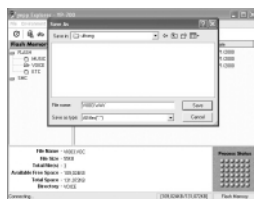
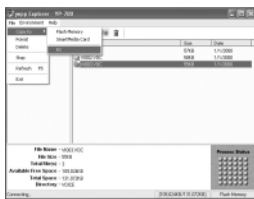

\* In case of uploading VOC, it is saved in WAV.

## Rearranging Files

You can change the order that the files are played.

**1** Before rearranging files, turn on the yEPP and connect yEPP to PC.

**2** Run yEPP Explorer.

**3** Select files to move.



**4** Drag & drop the selected file to where you wish it to be.

**Note :** Due to the copyright law, MP3 and WMA, SMP, SM3 files can't be transferred to PC.

**Note :** Files cannot be rearranged on the Mac.

# Description of Buttons (yopp Player)



BUTTON	STATUS	PRESSING LENGTH	RESPONSE
▶ / ■	Power Off		Power On, and play
	Play		Stop(When no button is pressed for 5 seconds, yopp powers off automatically)
	MENU Mode		Selection
	Voice Recording		Pause
	Voice Recording Pause		Resume recording
	Intro Play		Cancel Intro play and change to Normal play
	▶▶	Play	Less than 1 second
▶▶	Play	Longer than 1 Second	Fast forward search in PLAY mode
	Stop		Skip to the next track
	MENU Mode		Move upward

◀◀	Play	Less than 1 Second	Within 5 seconds from the start: Plays the previous track After 5 seconds from the start: Plays the current track from the beginning.
	Play	Longer than 1 Second	Fast reverse search in PLAY mode
	Stop		Skips to the previous track
	MENU Mode		Move downward
+	Play or Stop Mode		Volume increase
-	Play or Stop Mode		Volume decrease
MODE	Play	Less than 1 second	Set the starting point for loop function
	During Loop Setting	Less than 1 second	Loop mode
	Loop Mode	Less than 1 second	Cancel loop mode
	Stop	Less than 1 second	Changing modes (music↔voice)
	Play or Stop Mode	Longer than 2 Seconds	Enter MENU
	MENU Mode		Exiting MENU
●	Stop Mode		Start to record
	While Recording		Stop voice recording
	Memory Selection in Recording		Select

# MENU Table



## MENU

Select with the ▶/■ button and move with the ◀◀/▶▶ button.

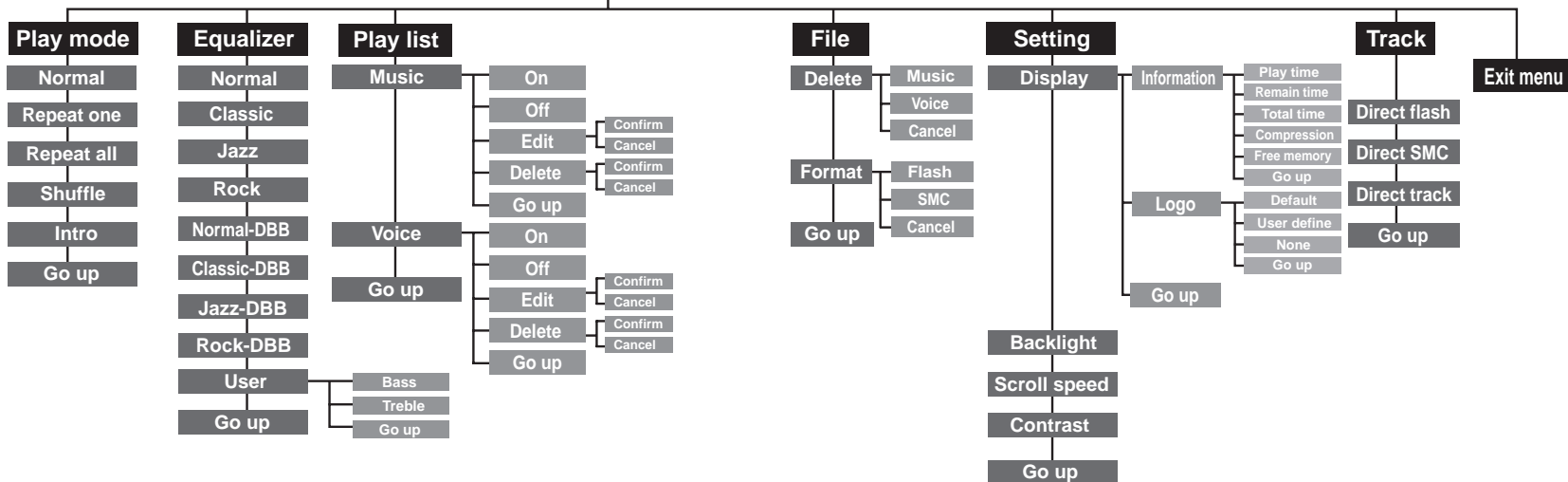

# Precautions

- ✿ Keep yepp and all its parts and accessories out of the reach of small children.
- ✿ Do not use or store yepp in dusty, dirty areas as its components may be damaged.
- ✿ Do not drop or put weight on the unit.
- ✿ Make sure not to let water in yepp.
  - If it gets wet, remove the battery, dry it with towel and contact a service center.
- ✿ Keep out of humid, hot or magnetic places.
- ✿ Do not clean it with thinner, alcohol or benzene.

# Troubleshooting

## Software does not work.

- Refer to pages 38, 46.(computer environment)

## yepp does not work and the LCD displays nothing.

- Check the battery capacity
- Check to see if the battery is inserted correctly (+ / -)

## The buttons do not work.

- Check to see if HOLD switch is set for HOLD.

## In PLAY mode, music is not played after pressing the ►/■ button

- Check to see if MP3 or WMA files are saved in the built-in memory or SmartMedia card.

## Files cannot be downloaded.

- Check to see if the driver is installed correctly in the computer.
  - Check the connection between yepp and computer.
  - Check and/or replace the battery, turn on the yepp.
  - In FM mode,you can't connect yepp to computer.
- To connect yepp to computer, convert the yepp mode by pressing the remote controller MODE button.

## Backlight does not work.

- Check the backlight setup.
- When the battery power is low, the backlight will go out.

## yepp keeps being turned off.

- In Stop mode, the power is automatically turned off after five seconds.
- Check to see if there are files saved in it.

## Something's wrong with play time displayed during Play mode.

- Check to see if it is playing VBR(Variable Bit Rate) files. VBR files are not fully supported.

## LCD window is dark

- Check Contrast

## Files on the SmartMedia card are not recognized.

- Check to see if SmartMedia card is inserted correctly. Push SmartMedia card into slot again.
- Format the SmartMedia card again and save files.

## Strange letters are displayed

- Check the font set up.

# Security

You can get legal MP3 files from a growing number of Internet sites.

## What is SecuMax?

With the increasing amount of digital multimedia content, the content providers became concerned with the ease in which the content could be copied and distributed in violation of their copyrights. This matter required a system called SecuMAX for protecting copyrighted music and for using legal content conveniently.

- ◆ SecuMAX protects the copyrighted music against infringement.
- ◆ SecuMAX can be adapted to various types of digital contents.
- ◆ For further details on SecuMAX, please visit [www.secumax.com](http://www.secumax.com)

## Internet Site

[www.cddb.com](http://www.cddb.com)

- Music CD-related data is provided through the Internet from the CDDB™ Music CD Database.
- Copyright©1998 CDDB Inc. All rights reserved.

### Note :

To listen to MP3 files encoded with SecuMAX, you must download the key file from the Internet and register it on the yepp' Explorer.



# Specifications

Model	YP-700
Processor	74Mips RISC
Built-in Memory capacity	192MB(YP-700i)/128MB(YP-700H)/64MB(YP-700S)
Voltage	1.5V(AAA size alkaline battery)/1.2V(NI-MH Rechargeable battery)
Playing time	last 20hours ( A Rechargeable battery+AAA size alkaline battery)
Dimensions/Weight	2.1" X 3.4" X 0.55"/2.4 oz. without a battery
Case	Plastic/Aluminum
File Transfer Speed	Up to 5Mbps
Noise Ratio	80dB with 20kHz LPF
Earphones Jack Output Power	5mW @ 16
Output Frequency Range	20Hz~20kHz
Operating Temperature Range	-5 ~ +35°C (23 ~ 95F)

Charger Model	ORC-238
Available Rechargeable Battery	NI-MH Rechargeable Slim Battery
Charging time	About 4 hours
Input Rating	120V ~ 60z
Output Rating	1.2V == 0.35A



# Safety Information



FCC Part 15: This equipment has been tested and found to comply with the limits for a Class B digital device, pursuant to Part 15 of the FCC Rules. These limits are designed to provide reasonable protection against harmful interference in a residential installation.

This equipment generates, uses, and can radiate radio frequency energy and, if not installed and used in accordance with the instructions, may cause harmful interference to radio communications. However, this notice is not a guarantee that interference will not occur in a particular installation. If this equipment does cause harmful interference to radio or television reception, which can be determined by turning the equipment off and on, the user is encouraged to try one or more of the following measures:

- Reorient or relocate the receiving antenna.
- Increase the distance between the equipment and receiver.
- Connect the equipment to an outlet on a circuit different from that to which the receiver is connected.
- Consult the dealer or an experienced radio/TV technician.

## Modifications

Any changes or modifications not expressly approved by the grantee of this device could void the user's authority to operate the device.

## Compliance

This product conforms to the following Council Directive:

- Directive 89/336/EEC, 92/31/EEC(EMC)

## Declaration of Conformity

Name: Samsung Electronics Co., Ltd  
Address: 416, Maetan-3Dong, Paldal-Gu, Suwon City, Kyungki-Do, Korea 442-742

declares under its sole responsibility that the product  
Trade Name: Samsung Electronics Co., Ltd  
Model Number: YP-700  
has been tested according to the FCC/CISPR22/95 requirements for Class B devices and found compliant with the following standards

EMI/EMC: AnSI C63.4 1992, FCC Part 15 Subpart B

This device complies with part 15 of the FCC Rules.

Operation is subject to the following two conditions:

1. This device may not cause harmful interference, and
2. This device must accept any interference received, including interference that may cause undesirable operation.

Party Responsible for Product Compliance

Samsung Electronics America  
QA Lab.  
3351 Michelson Dr. Suite #290  
Irvine, CA92612

Tel : 949-975-7302



**Samsung warrants this product as free of defects in material, design and workmanship for the period of twelve(12) months from the original date of purchase.**

If during the period of warranty this product proves defective under normal use and service, you should return the product to the retailer from whom it was originally purchased. The liability of Samsung and its appointed maintenance company is limited to the cost of repair and/or replacement of the unit under warranty. Return of the product for defective reasons should be to the original purchaser, however Samsung Authorized Dealers and Authorized Service Centers will comply with the warranty on the terms issued to purchasers in the country concerned, for further information relating to the Authorized Service Centers contact. 1-800-SAMSUNG (1-800-726-7864) [www.samsungyepp.com](http://www.samsungyepp.com)

## WARRANTY CONDITIONS:

1. The warranty is only valid when the warranty card is properly completed, and upon presentation of the proof of purchase consisting of original invoice or sales slip confirmation, indicating the date of purchase, dealers name, model, serial No. and product number. Samsung reserves the right to refuse warranty service if this information has been removed or changed after the original purchase of the product from the dealer.
2. Samsung's obligations are to the repair of the defective part, and at its discretion, replacement of the product (service exchange unit).
3. Warranty repairs must be carried out by an Authorized Samsung Dealer/Service Center. No reimbursement will be made for repairs carried out by non Samsung Centers, and warranty coverage will not be valid for any repairs or damage caused by such repairs.
4. Repair or replacement under the terms of this warranty does not give right to extension to or a new starting of the period of warranty. Repair or direct replacement under the terms of this warranty may be fulfilled with functionally equivalent service exchange units.

5. The warranty is not applicable in cases other than defects in material, design and workmanship. The warranty does not cover the following:

- ◆ Periodic checks, maintenance, repair and replacement of parts due to normal wear and tear.
- ◆ Abuse or misuse, including but not solely limited to the failure to use this product for its normal purpose or in accordance with Samsung's instructions usage and maintenance.
- ◆ The product has been used in conjunction with accessories not approved by Samsung for use with this product.
- ◆ Failure of the product arising from incorrect installation or use not consistent with technical or safety standards in current force, or failure to comply with product manual instructions.
- ◆ Accidents, Acts of God or any cause beyond the control of Samsung caused by lightning, water, fire, public disturbances and improper ventilation.

- ◆ Unauthorized modifications carried out for the product to comply with local or national technical standards in countries for which the Samsung product was not originally designed.
  - ◆ Repairs performed by non-authorized service centers such as opening of the product by a non-authorized person.
  - ◆ The model, serial No. and product number on the product has been altered, deleted, removed or made illegible.
6. This warranty does not affect the consumers statutory rights nor the consumers rights against the dealer from their purchase/sales agreement.



THERE ARE NO EXPRESS WARRANTIES OTHER THAN THOSE LISTED AND DESCRIBED ABOVE, AND NO WARRANTIES WHETHER EXPRESS OR IMPLIED, INCLUDING, BUT NOT LIMITED TO, ANY IMPLIED WARRANTIES OF MERCHANTABILITY OR FITNESS FOR A PARTICULAR PURPOSE, SHALL APPLY AFTER THE EXPRESS WARRANTY PERIODS STATED ABOVE, AND NO OTHER EXPRESS WARRANTY OR GUARANTY GIVEN BY ANY PERSON, FIRM OR CORPORATION WITH RESPECT TO THIS PRODUCT SHALL BE BINDING ON SAMSUNG, SAMSUNG SHALL NOT BE LIABLE FOR LOSS OF REVENUE OR PROFITS, FAILURE TO REALIZE SAVINGS OR OTHER BENEFITS, OR ANY OTHER SPECIAL, INCIDENTAL OR CONSEQUENTIAL DAMAGES CAUSED BY THE USE, MISUSE OR INABILITY TO USE THIS PRODUCT, REGARDLESS OF THE LEGAL THEORY ON WHICH THE CLAIM IS BASED, AND EVEN IF SAMSUNG HAS BEEN ADVISED OF THE POSSIBILITY OF SUCH DAMAGES. NOR SHALL RECOVERY OF ANY KIND AGAINST SAMSUNG BE GREATER IN AMOUNT THAN THE PURCHASE PRICE OF THE PRODUCT SOLD BY SAMSUNG AND CAUSING THE ALLEGED DAMAGE. WITHOUT LIMITING THE FOREGOING, PURCHASER

- ASSUMES ALL RISK AND LIABILITY FOR LOSS,
- DAMAGE OR INJURY TO PURCHASER AND
- PURCHASER'S PROPERTY AND TO OTHERS AND
- THEIR PROPERTY ARISING OUT OF THE USE,
- MISUSE OR INABILITY TO USE THIS PRODUCT SOLD
- BY SAMSUNG NOT CAUSED DIRECTLY BY THE
- NEGLIGENCE OF SAMSUNG. THIS LIMITED
- WARRANTY SHALL NOT EXTEND TO ANYONE
- OTHER THAN THE ORIGINAL PURCHASER OF THIS
- PRODUCT, IS NONTRANSFERABLE AND STATES
- YOUR EXCLUSIVE REMEDY.

- Some states do not allow limitations on how long an implied warranty lasts, or the exclusion or limitation of incidental or consequential damages, so the above limitations or exclusions may not apply to you. This warranty gives you specific legal rights, and you may also have other rights which vary from state to state.
- This product is for personal use only, and is only for use in compliance with the limitations of copyright and other laws.

To obtain warranty service, please contact SAMSUNG at:  
 Samsung Electronics America, Inc.  
 400 Valley Road, Suite 201 Mount Arlington, NJ 07856  
 Tel: (973) 601-6000, Fax: (973) 601-6001  
 1-800-SAMSUNG (1-800-726-7864)  
[www.samsungyepp.com](http://www.samsungyepp.com)  
 081299

**MEMO**

**MEMO**

A large, empty, rounded rectangular box with a thin black border, intended for writing notes or a memo.A large, empty, rounded rectangular box with a thin black border, identical to the one on the left, intended for writing notes or a memo.